



 **MAGICK
HOME**

WHERE DESIGN MEETS DELIGHT

THE MAGICK HOME STANDARD

At Magick Home, we do more than make cabinets—
we create the home of your dreams.



QUICK QUOTE

Our online Digital Designer tool makes it fast and fun to visualize your new kitchen and get a quote!



FREE DESIGN

Fill out the form on our website and receive a full expert room design within 48 hours!



INCREDIBLE VALUE

The selection and quality we offer is rare to find at this price point.



EXCEPTIONAL SERVICE

You're in good hands with our friendly team. We know cabinets, inside and out.



QUICK SHIP

We'll ship out within just 3 weeks—faster than the industry standard.

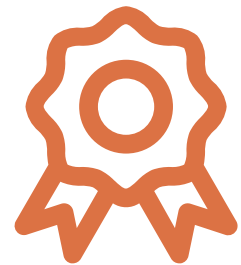

LIMITED LIFETIME WARRANTY

Rest assured knowing every product is covered under our extensive warranty.

SUPERIOR CONSTRUCTION

THE DIFFERENCE IS IN THE DETAILS



1 5/8-inch side gables for superior strength & durability.

2 Sturdy slim-line metal drawer boxes with full-extension undermount glides hold up to 75 lbs.

3 Water- and stain-resistant melamine interior cabinet boxes.

4 3/4-inch full-depth shelves for heavier storage capacity.

5 Designer linen pattern interior.

6 Frameless full-access construction eliminates the face frame around cabinets for a modern look & extra storage space.

7 Tool-free press-in hinges are easy-to-adjust.

8 Soft-close doors and drawers for quiet use.

9 Pre-installed adjustable legs provide easy levelling on uneven floors.

GET INSPIRED!



Want to start planning right this second? You can use the Magick Home Digital Designer to visualize different layouts and get real-time price estimates.

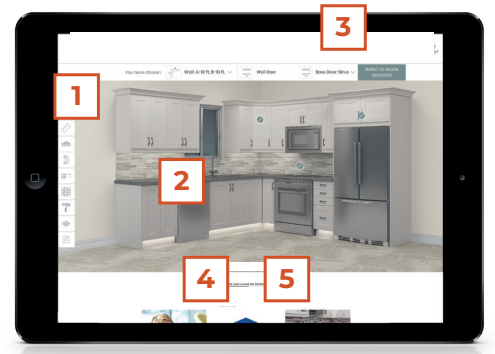

1 Quick-click menu: choose layout, measurements, door styles, handles, and more!

2 See the image change instantly.

3 On-screen reminder of your choices.

4 Cabinet order list is automatically generated.

5 Receive free instant estimates.

FREE EXPERT DESIGN

Let our Magick Home designers plan out your dream room for free—from the comfort of your own home!

1

PLAN

Fill out the free design form on our website with as many details as you can, like measurements, a photo of your space, and choice of door style.



VISIT US ONLINE
TO GET STARTED!

2

PROPOSE

In less than 48 hours, you'll receive a completed room design, including a blueprint, 3-D room rendering, and price list with full product details.

3

PERFECT

Send any revisions to our designer—we'll keep working with you until it's exactly right.



DOOR



WILLOW

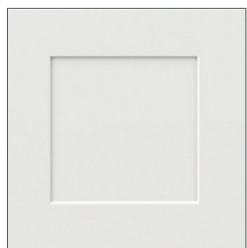

JASMINE



SEA HOLLY

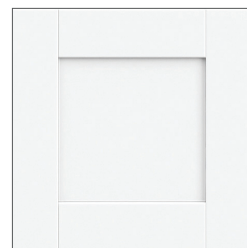

DAHLIA

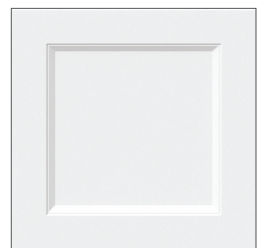

MAGNOLIA

STYLES



SUMMERINA



WISTERIA



CAMELLIA



CORDYLINE

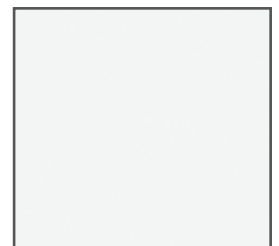

LILY

COLLECTIONS



Distinctively rich, this slate grey shaker effortlessly radiates a refined warmth and beauty.



WILLOW

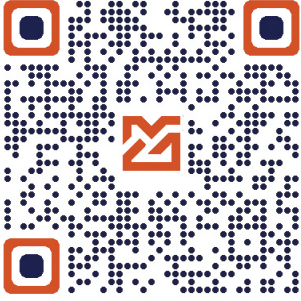

[VIEW ONLINE](#)



JASMINE



VIEW ONLINE



A forever classic, this creamy warm white shaker creates an inviting, cozy space.





CORDYLINE

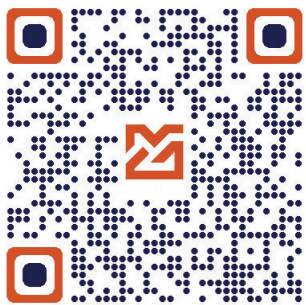
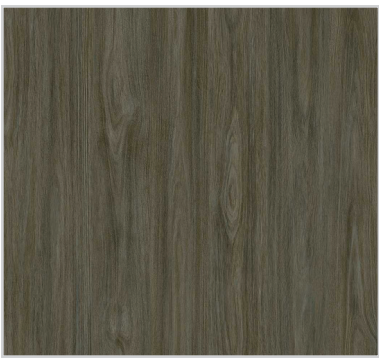

VIEW ONLINE



A rich, slab-style door brings an elevated minimalist look to your home.



SEA HOLLY



VIEW ONLINE





Soft and sophisticated, this light grey shaker offers an elegant style that will stand the test of time.



Always in style, our bright white shaker is easy to contrast or coordinate for a fresh, bright space.



DAHLIA

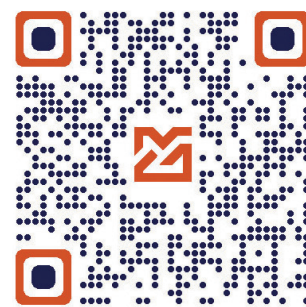

VIEW ONLINE





CAMELLIA

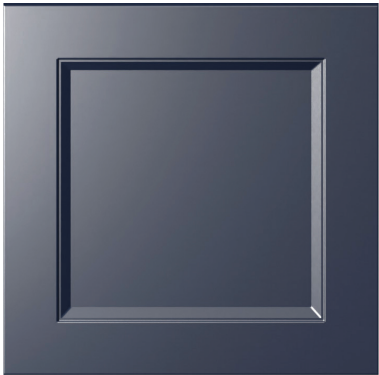

[VIEW ONLINE](#)



Versatile and unique, a navy door can add bold depth or a sense of serene calm.



A simple bright white slab door is made for modern designs—plus, it coordinates perfectly with any accent colour.



LILY



VIEW ONLINE





Classic and timeless, this bright white recessed panel style looks clean on its own and matches perfectly with other neutrals or colours.

MAGNOLIA

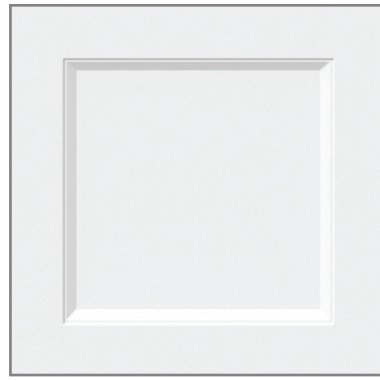

VIEW ONLINE



WISTERIA

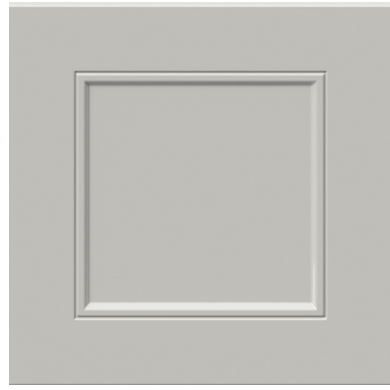

VIEW ONLINE



This neutral light grey door has a beaded inner panel, offering the perfect balance of simplicity and detail.





CABINETRY FOR THE WHOLE HOME

It's easy to combine Magick Home cabinets to create functional and beautiful storage for your whole home: the mudroom, entertaining spaces, office, laundry room, bathroom, and more!



Sea Holly



Willow



YOUR KITCHEN PRIORITY SCALE

Assess your preferences to create your perfect kitchen.



STORAGE

Lots of cabinets for hiding everything away, plus clever internal features

Low Priority

High Priority



ENTERTAINING

Extra seating and space to make memories with family & friends

Low Priority

High Priority



BAKING & COOKING

Serious prep space and built-in dedicated baking areas

Low Priority

High Priority



WORKSPACE

A designated area to work from home, complete art projects, or do paperwork

Low Priority

High Priority



FAMILY-FRIENDLY

Considered kid zones and spaces for pets

Low Priority

High Priority



ELECTRONICS

Outlet-accessible counter space for chargers, tablets, & more

Low Priority

High Priority



YOUR CHECKLIST

What you need to do before you speak to one of our design specialists

- 1** **FIND YOUR STYLE**
Gather inspiration from magazines, Pinterest, and your imagination. Figure out what you love—and what you don't.
- 2** **TAKE PICTURES**
Take as many photos of your current space as possible, including every angle and the full length of the room. (Don't worry, they don't need to be fancy.)
- 3** **GET MEASUREMENTS**
Measure your walls, ceilings, doorways, and openings. Use the QR code on this page to access our helpful measuring guide.
- 4** **WORK OUT YOUR BUDGET**
Figure out what you want to spend, noting any areas you'd be willing to splurge on—like your dream kitchen island. For a sense of what to expect, get a quick quote with our online Kitchen Visualizer.
- 5** **ESTABLISH A TIMELINE**
Consider when you'll be ready for renovations in your home. If you have a hard deadline, make note of that. For time-sensitive projects, we're proud to ship in just 3 weeks—plus, you'll receive your room design within 48 hours.
- 6** **REACH OUT**
Congrats! You're now ready to fill out our design request form and connect with our team. Scan the QR code on this page to begin.

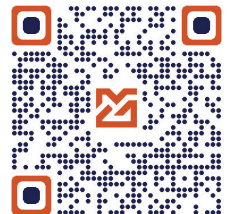

CONTACT US

DOORS & DRAWER FRONTS

Here are our door styles at a glance. Each style comes in a wide choice of door and drawer sizes, available separately so you can create your ideal layout.



DOOR FRONTS (W X D X H)

12 x 3/4 x 10"	12 x 3/4 x 25"	9 x 3/4 x 35"
13 1/2 x 3/4 x 10"	13 1/2 x 3/4 x 25"	12 x 3/4 x 35"
15 x 3/4 x 10"	15 x 3/4 x 25"	13 1/8 x 3/4 x 35"
16 1/2 x 3/4 x 10"	16 1/2 x 3/4 x 25"	13 1/2 x 3/4 x 35"
18 x 3/4 x 10"	18 x 3/4 x 25"	15 x 3/4 x 35"
12 x 3/4 x 15"	21 x 3/4 x 25"	16 1/2 x 3/4 x 35"
13 1/2 x 3/4 x 15"	24 x 3/4 x 25"	18 x 3/4 x 35"
15 x 3/4 x 15"	9 x 3/4 x 30"	21 x 3/4 x 35"
16 1/2 x 3/4 x 15"	11 x 3/4 x 30"	24 x 3/4 x 35"
18 x 3/4 x 15"	12 x 3/4 x 30"	
12 x 3/4 x 20"	13-1/8 x 3/4 x 30"	
13 1/2 x 3/4 x 20"	13 1/2 x 3/4 x 30"	
15 x 3/4 x 20"	15 x 3/4 x 30"	
16 1/2 x 3/4 x 20"	16 1/2 x 3/4 x 30"	
18 x 3/4 x 20"	18 x 3/4 x 30"	
21 x 3/4 x 20"	21 x 3/4 x 30"	
24 x 3/4 x 20"	24 x 3/4 x 30"	

DRAWER FRONTS (W X D X H)

12 x 3/4 x 5"	12 x 3/4 x 15"
15 x 3/4 x 5"	15 x 3/4 x 15"
18 x 3/4 x 5"	18 x 3/4 x 15"
21 x 3/4 x 5"	21 x 3/4 x 15"
24 x 3/4 x 5"	24 x 3/4 x 15"
27 x 3/4 x 5"	27 x 3/4 x 15"
30 x 3/4 x 5"	30 x 3/4 x 15"
33 x 3/4 x 5"	33 x 3/4 x 15"
36 x 3/4 x 5"	36 x 3/4 x 15"
12 x 3/4 x 10"	
15 x 3/4 x 10"	
18 x 3/4 x 10"	
21 x 3/4 x 10"	
24 x 3/4 x 10"	
27 x 3/4 x 10"	
30 x 3/4 x 10"	
33 x 3/4 x 10"	
36 x 3/4 x 10"	

GLASS DOOR FRONTS (W X D X H)

13 1/8 x 3/4 x 30"
13 1/8 x 3/4 x 35"
15 x 3/4 x 30"
15 x 3/4 x 35"
18 x 3/4 x 30"
18 x 3/4 x 35"

All glass doors include clear tempered glass with matching frames*

*Lily glass doors have a Dahlia style frame

Choose from our extensive collection of shallow base cabinets available in all the shapes and sizes you need.

BASE CABINET OPTIONS

These cabinets are 34 1/2" high (including legs) x 24" deep. Width options are listed with each cabinet.

BASE CABINETS >

1 DOOR

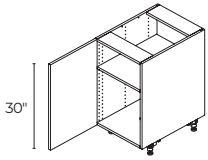

9" | B9FH(L/R)
12" | B12FH(L/R)
15" | B15FH(L/R)
18" | B18FH(L/R)
21" | B21FH(L/R)
24" | B24FH(L/R)

1 DOOR / 3 INNER DRAWERS

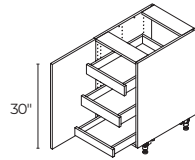

15" | B15FHI3(L/R)
18" | B18FHI3(L/R)
21" | B21FHI3(L/R)
24" | B24FHI3(L/R)

1 DOOR / 1 DRAWER

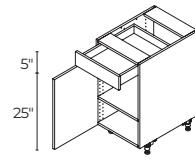

12" | B12(L/R)
15" | B15(L/R)
18" | B18(L/R)
21" | B21(L/R)
24" | B24(L/R)

1 DOOR / 1 DRAWER

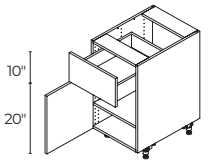

12" | B12A(L/R)
15" | B15A(L/R)
18" | B18A(L/R)
21" | B21A(L/R)
24" | B24A(L/R)

1 DOOR / 2 DRAWERS

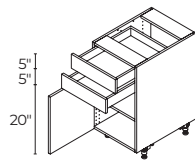

12" | B12B(L/R)
15" | B15B(L/R)
18" | B18B(L/R)
21" | B21B(L/R)
24" | B24B(L/R)

2 DRAWERS

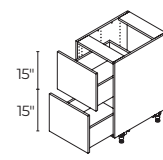

12" | B2D12 27" | B2D27
15" | B2D15 30" | B2D30
18" | B2D18 33" | B2D33
21" | B2D21 36" | B2D36
24" | B2D24

2 DRAWERS / 1 INNER DRAWER

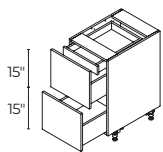

12" | B2D12I1 27" | B2D27I1
15" | B2D15I1 30" | B2D30I1
18" | B2D18I1 33" | B2D33I1
21" | B2D21I1 36" | B2D36I1
24" | B2D24I1

3 DRAWERS

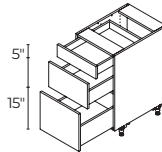

12" | B3D12 27" | B3D27
15" | B3D15 30" | B3D30
18" | B3D18 33" | B3D33
21" | B3D21 36" | B3D36
24" | B3D24

3 DRAWERS

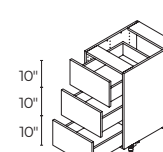

12" | B3DA12 27" | B3DA27
15" | B3DA15 30" | B3DA30
18" | B3DA18 33" | B3DA33
21" | B3DA21 36" | B3DA36
24" | B3DA24

3 DRAWERS / 1 INNER DRAWER

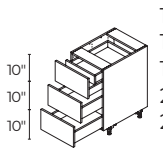

12" | B3DA12I1 27" | B3DA27I1
15" | B3DA15I1 30" | B3DA30I1
18" | B3DA18I1 33" | B3DA33I1
21" | B3DA21I1 36" | B3DA36I1
24" | B3DA24I1

4 DRAWERS

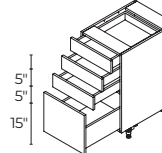

12" | B4D12 27" | B4D27
15" | B4D15 30" | B4D30
18" | B4D18 33" | B4D33
21" | B4D21 36" | B4D36
24" | B4D24

6 DRAWERS

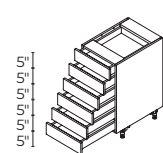

12" | B6D12 27" | B6D27
15" | B6D15 30" | B6D30
18" | B6D18 33" | B6D33
21" | B6D21 36" | B6D36
24" | B6D24

2 DOORS

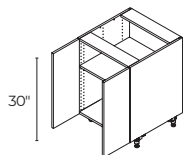

24" | B24-2FH
27" | B27FH
30" | B30FH
33" | B33FH
36" | B36FH

2 DOORS / 3 INNER DRAWERS

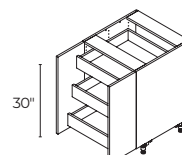

24" | B24-2FHI3
27" | B27FHI3
30" | B30FHI3
33" | B33FHI3
36" | B36FHI3

2 DOORS / 1 DRAWER

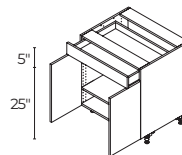

27" | B27
30" | B30
33" | B33
36" | B36

2 DOORS / 1 DRAWER

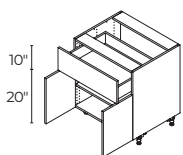

27" | B27A
30" | B30A
33" | B33A
36" | B36A

2 DOORS / 2 DRAWER

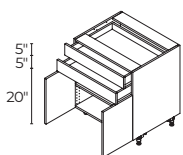

27" | B27B
30" | B30B
33" | B33B
36" | B36B

CORNER CABINETS >

BLIND CORNER WITH SHELF



39" | BBCL39
39" | BBCR39

Min. 42 3/4" doesn't allow for filler / hardware clearance. Max. 48 3/4" is with 6" filler attached to be flush with door - filler not included.

BLIND CORNER WITH PULL-OUT

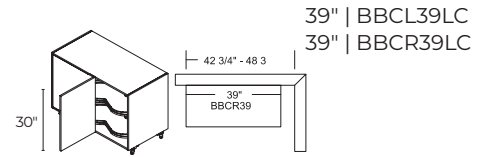

39" | BBCL39LC
39" | BBCR39LC

SINK CABINETS >

CORNER WITH LAZY SUSAN

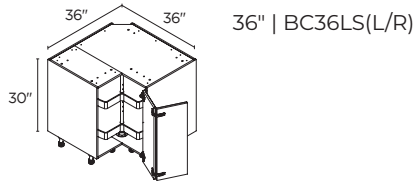

36" | BC36LS(L/R)

CORNER WITH SHELF

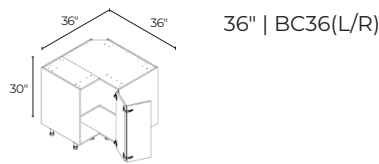

36" | BC36(L/R)

1 DOOR

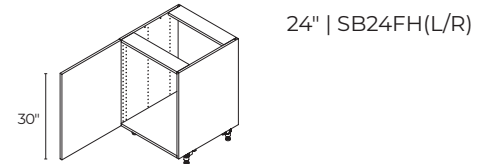

24" | SB24FH(L/R)

1 DOOR / 1 FIXED FRONT

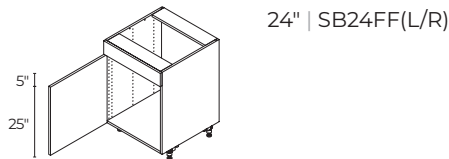

24" | SB24FF(L/R)

2 DOORS

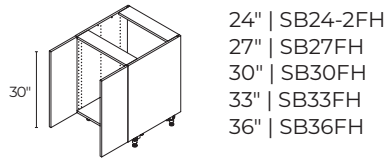

24" | SB24-2FH
27" | SB27FH
30" | SB30FH
33" | SB33FH
36" | SB36FH

2 DOORS / 1 FIXED FRONT

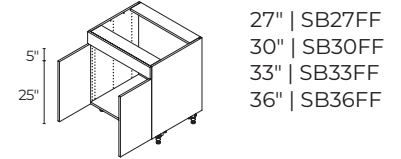

27" | SB27FF
30" | SB30FF
33" | SB33FF
36" | SB36FF

FARM SINK CABINETS >

2 DOORS

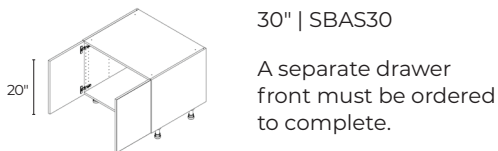

30" | SBAS30

A separate drawer front must be ordered to complete.

2 DOORS

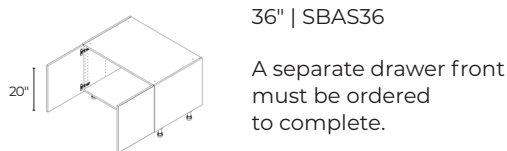

36" | SBAS36

A separate drawer front must be ordered to complete.

MICROWAVE CABINET >

1 DRAWER

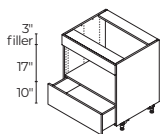

30" | BMW30

Cut-out size:
28 1/2" wide x 17" high.
Filler can be cut to adjust height opening 17" to 20".

COOKTOP CABINETS >

2 DOORS / 1 DRAWER

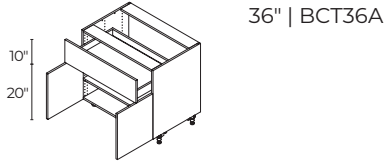

2 DOORS / 1 FIXED FRONT

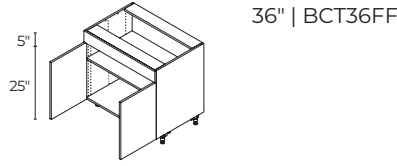

2 DOORS / 1 DRAWER / 1 FIXED FRONT

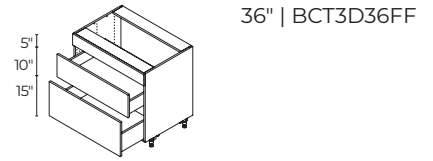

2 DRAWERS / 1 FIXED FRONT

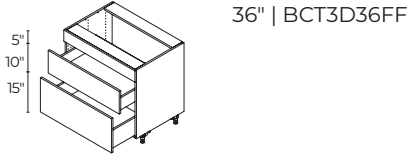

2 DRAWERS / 1 INNER DRAWER

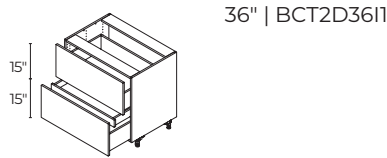

3 DRAWERS

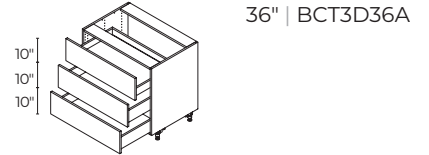

3 DRAWERS / 1 FIXED FRONT

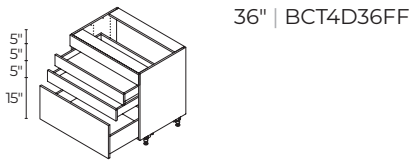

WASTE/RECYCLE CABINETS >

PULL-OUT / 1 DRAWER

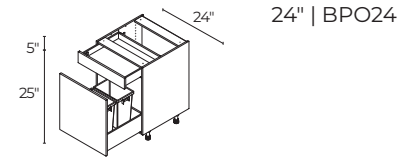
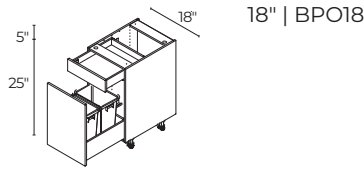
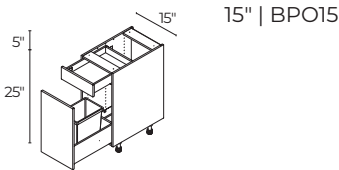

BASE WINDOW SEAT >

1 DRAWER

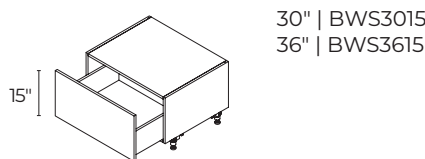
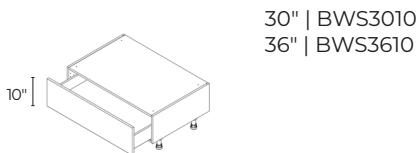

SHALLOW BASE CABINET OPTIONS

Choose from our extensive collection of shallow base cabinets available in all the shapes and sizes you need. These cabinets are 34 ½" high (including legs) x 14" deep. Width options are listed with each cabinet.

SHALLOW BASE CABINETS >

1 DOOR

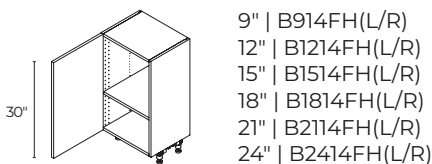

1 GLASS DOOR

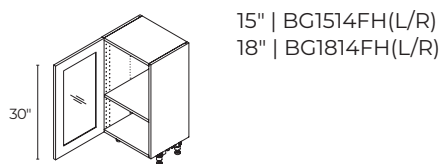

1 DOOR / 3 INNER DRAWERS

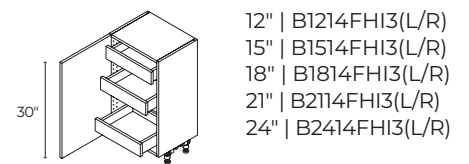

1 DOOR / 1 DRAWER

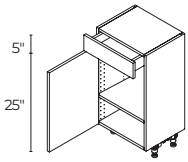

15" | B1514(L/R)
18" | B1814(L/R)
24" | B2414(L/R)

1 DOOR / 2 DRAWERS

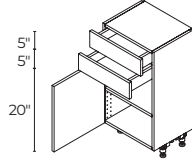

15" | B1514B(L/R)
18" | B1814B(L/R)
24" | B2414B(L/R)

1 DOOR / 3 DRAWERS

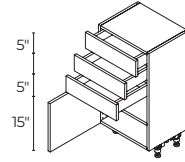

15" | B1514C(L/R)
18" | B1814C(L/R)

2 DOORS

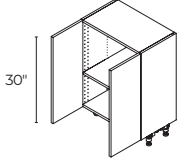

24" | B2414-2FH
27" | B2714FH
30" | B3014FH
33" | B3314FH
36" | B3614FH

2 GLASS DOORS

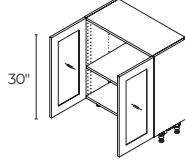

30" | BG3014FH
36" | BG3614FH

2 DOORS / 3 INNER DRAWERS

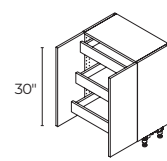

24" | B2414-2FHI3
27" | B2714FHI3
33" | B3314FHI3

6 DRAWERS

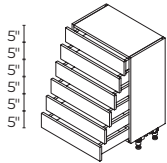

15" | B6D1514
18" | B6D1814
24" | B6D2414

BASE OPEN SHELF

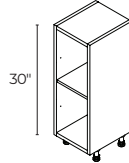

9" | BOS930

BASE WINE RACK

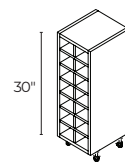

9" | BWR930

WALL CABINET OPTIONS

Our wall and glass door wall cabinets are 14" deep while our deep and corner wall cabinets are 24" deep. Height and width options are listed with each cabinet.

WALL CABINETS >

10" HIGH 2 DOORS

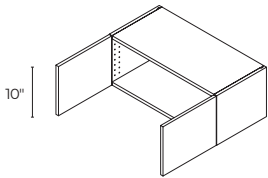

27" | W2710
30" | W3010
33" | W3310
36" | W3610

15" HIGH 2 DOORS

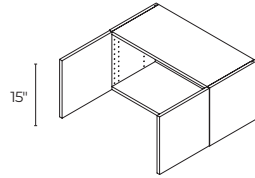

27" | W2715
30" | W3015
33" | W3315
36" | W3615

20" HIGH 2 DOORS

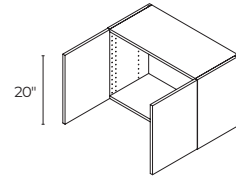

27" | W2720
30" | W3020
33" | W3320
36" | W3620

30" HIGH 1 DOOR

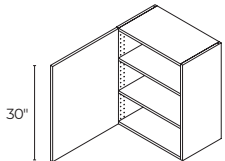

9" | W930(L/R)
12" | W1230(L/R)
15" | W1530(L/R)
18" | W1830(L/R)
21" | W2130(L/R)
24" | W2430(L/R)

30" HIGH 1 GLASS DOOR

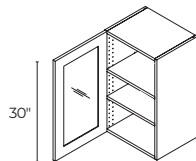

15" | WG1530(L/R)
18" | WG1830(L/R)

30" HIGH 2 DOORS

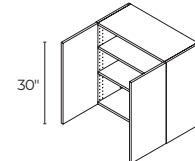

24" | W2430-2
27" | W2730
30" | W3030
33" | W3330
36" | W3630

30" HIGH 2 GLASS DOORS*

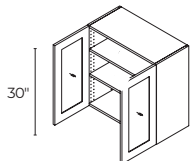

30" | WG3030
36" | WG3630

35" HIGH 1 DOOR

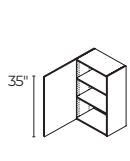

9" | W935(L/R) 27" | W2735(L/R)
12" | W1235(L/R) 33" | W3335(L/R)
15" | W1535(L/R)
18" | W1835(L/R)
21" | W2135(L/R)
24" | W2435(L/R)

35" HIGH 1 GLASS DOOR*

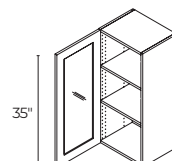

15" | WG1535(L/R)
18" | WG1835(L/R)

35" HIGH 2 DOORS

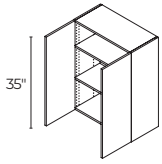

24" | W2435-2
27" | W2735
30" | W3035
33" | W3335
36" | W3635

35" HIGH 2 GLASS DOORS*

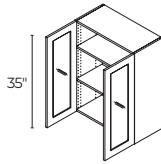

30" | WG3035
36" | WG3635

35" HIGH 1 DOOR / 1 DRAWER

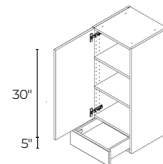

15" | W1535A(L/R)
18" | W1835A(L/R)
24" | W2435A(L/R)

35" HIGH 1 GLASS DOOR* / 1 DRAWER

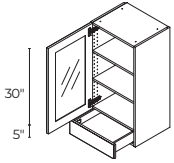

15" | WG1535A(L/R)
18" | WG1835A(L/R)

35" HIGH 1 DOOR / 2 DRAWERS

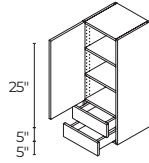

15" | W1535B(L/R)
18" | W1835B(L/R)
24" | W2435B(L/R)

35" HIGH 2 DOORS / 1 DRAWER

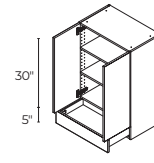

24" | W2435-2B

LIFT-UP WALL CABINETS >

10" HIGH 1 LIFT-UP DOOR

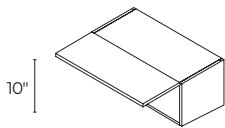

24" | WLU2410
27" | WLU2710
30" | WLU3010
33" | WLU3310
36" | WLU3610

15" HIGH 1 LIFT-UP DOOR

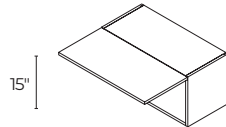

24" | WLU2415
27" | WLU2715
30" | WLU3015
33" | WLU3315
36" | WLU3615

15" HIGH 1 GLASS LIFT-UP DOOR

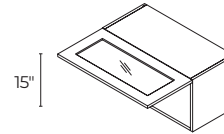

30" | WLUG3015

DEEP LIFT-UP WALL CABINETS >

10" HIGH 1 LIFT-UP DOOR

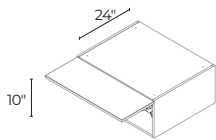

24" | WLU241024
27" | WLU271024
30" | WLU301024
33" | WLU331024
36" | WLU361024

15" HIGH 1 LIFT-UP DOOR

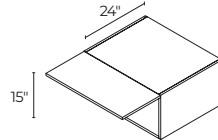

24" | WLU241524
27" | WLU271524
30" | WLU301524
33" | WLU331524
36" | WLU361524

DEEP WALL CABINETS >

10" HIGH 2 DOORS

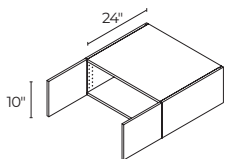

27" | W271024
30" | W301024
33" | W331024
36" | W361024

15" HIGH 2 DOORS

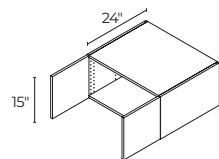

27" | W271524
30" | W301524
33" | W331524
36" | W361524

20" HIGH 2 DOORS

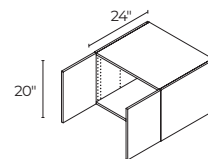

24" | W242024-2
27" | W272024
30" | W302024
33" | W332024
36" | W362024

WALL MICROWAVE SHELF >

15" HIGH

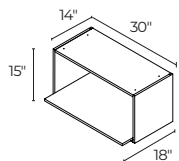

30" | WMS3015

Finished interior shelf is removable.



*Glass shelves can be purchased separately.

SPECIALTY WALL CABINETS >

WALL OPEN SHELF

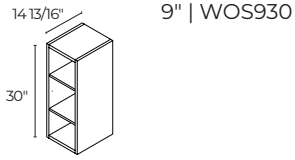

WALL WINE RACK

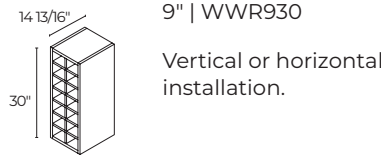

CORNER WALL CABINETS >

30" HIGH 1 DOOR

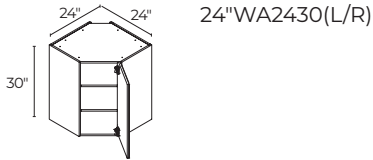

30" HIGH 1 GLASS DOOR*

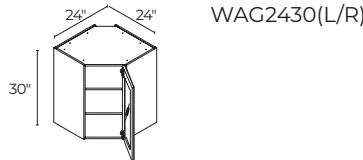

35" HIGH 1 DOOR

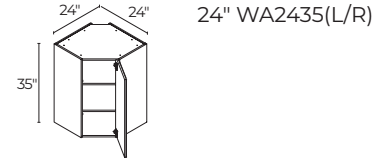

35" HIGH 1 GLASS DOOR*

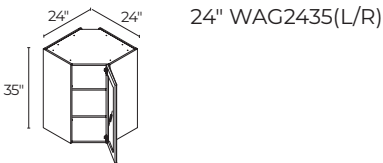

BLIND CORNER WALL CABINETS >

30" HIGH 1 DOOR

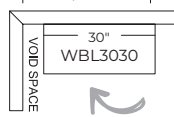
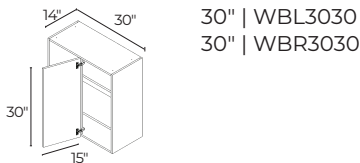

Max. 35" is with 6" filler attached to be flush with door - filler not included. Panel next to door is white for all collections. Filler is required.

35" HIGH 1 DOOR

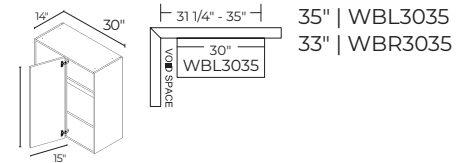

84 1/2" H TALL CABINET OPTIONS

These cabinets are 24" deep x 84 1/2" high. Width options are listed with each cabinet.

84 1/2" H TALL CABINETS >

3 DOORS

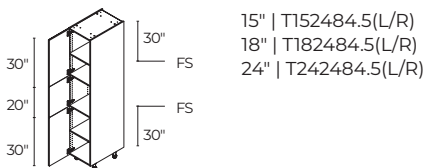

6 DOORS

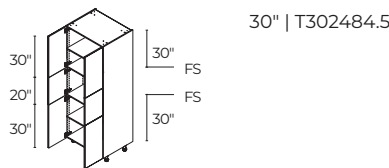

3 DOORS / 4 INNER DRAWERS

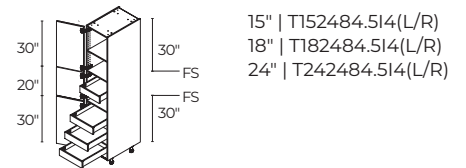

6 DOORS / 4 INNER DRAWERS

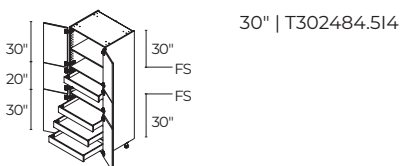

2 DOORS / 3 DRAWERS / 2 INNER DRAWERS

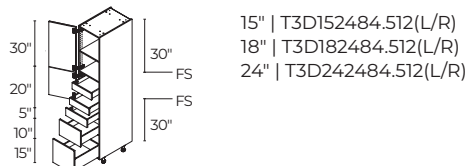

4 DOORS / 3 DRAWERS / 2 INNER DRAWERS



*Glass shelves can be purchased separately.

2 DOORS / 3 DRAWERS /
2 INNER DRAWERS

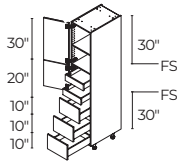

15" | T3DA152484.512(L/R)
18" | T3DA182484.512(L/R)
24" | T3DA242484.512(L/R)

4 DOORS / 3 DRAWERS /
2 INNER DRAWERS

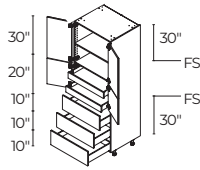

30" | T3DA302484.512

2 DOORS / 2 DRAWERS /
2 INNER DRAWERS

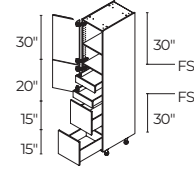

15" | T2D152484.512(L/R)
18" | T2D182484.512(L/R)
24" | T2D242484.512(L/R)

4 DOORS / 2 DRAWERS /
2 INNER DRAWERS

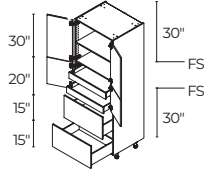

30" | T2D302484.512

84 1/2" H TALL APPLIANCE CABINETS >

MICRO/WALL OVEN ²
2 DOORS / 2 DRAWERS

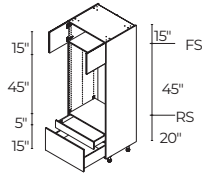

30" | TMO2D3084.5

MICRO/WALL OVEN ²
1 LIFT-UP DOOR / 2 DRAWERS

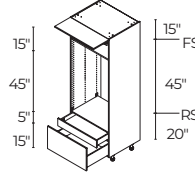

30" | TMO2D3084.5

MICRO/WALL OVEN ²
2 DOORS / 2 DRAWERS

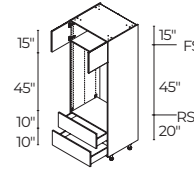

30" | TMO2DA3084.5

MICRO/WALL OVEN ²
1 LIFT-UP DOOR / 2 DRAWERS

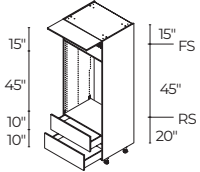

30" | TMO2DA3084.5

DOUBLE OVEN ³
1 LIFT-UP DOOR / 1 DRAWER

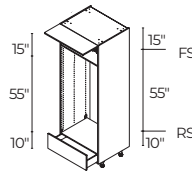

30" | TDOLA3084.5

SINGLE OVEN ⁴
4 DOORS

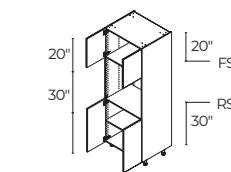

30" | TO3084.5

SINGLE OVEN ⁴
2 DOORS / 3 DRAWERS

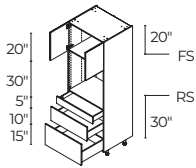

30" | TO3D3084.5

SINGLE OVEN ⁴
2 DOORS / 3 DRAWERS

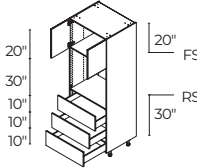

30" | TO3DA3084.5

DOUBLE OVEN ³
2 DOORS / 1 DRAWER

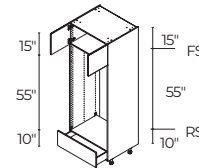

30" | TDOA3084.5

MICROWAVE ¹
4 DOORS

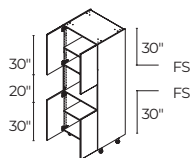

30" | TM3084.5

MICROWAVE ¹
2 DOORS / 2 DRAWERS

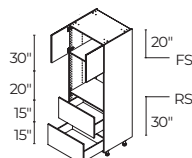

30" | TO2D3084.5

MICROWAVE ¹
2 DOORS / 3 DRAWERS

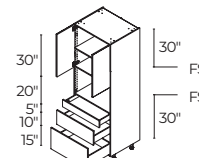

30" | TM3D3084.5

RS = Reinforced Shelf. FS = Fixed Shelf. Appliance cut-out sizes: (use of a filler is required and must be ordered separately): ¹28 1/2" width x 18 1/2" high. ²28 1/2" width x 43 1/2" high. ³28 1/2" width x 53 1/2" high. ⁴28 1/2" width x 28 1/2" high.

*Glass shelves can be purchased separately.

MICROWAVE ¹
2 DOORS / 3 DRAWERS

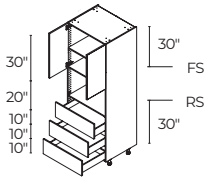

30" | TM3DA3084.5

MICROWAVE ¹
2 DOORS / 2 DRAWERS

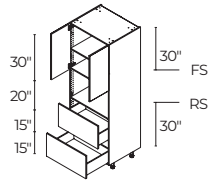

30" | TM2D3084.5

89 1/2" H TALL CABINET OPTIONS

Choose from our extensive collection of tall cabinets available in all the shapes and sizes you need. These cabinets are 24" deep x 89 1/2" high. Width options are listed with each cabinet.

3 DOORS

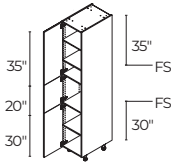

15" | T152489.5(L/R)
18" | T182489.5(L/R)
24" | T242489.5(L/R)

6 DOORS

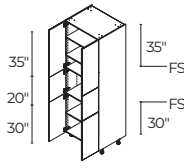

30" | T302489.5

3 DOORS / 3 INNER DRAWERS

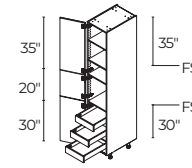

15" | T152489.5I3(L/R)
18" | T182489.5I3(L/R)
24" | T242489.5I3(L/R)

2 DOORS / 3 DRAWERS /
2 INNER DRAWERS

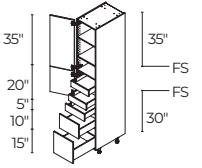

15" | T3D152489.5I2(L/R)
18" | T3D182489.5I2(L/R)
24" | T3D242489.5I2(L/R)

4 DOORS / 3 DRAWERS /
2 INNER DRAWERS

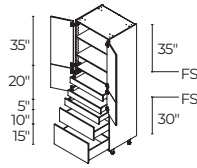

30" | T3D302489.5I2

2 DOORS / 3 DRAWERS /
2 INNER DRAWERS

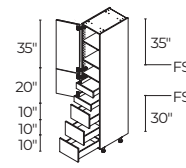

15" | T3DA152489.5I2(L/R)
18" | T3DA182489.5I2(L/R)
24" | T3DA242489.5I2(L/R)

4 DOORS / 3 DRAWERS /
2 INNER DRAWERS

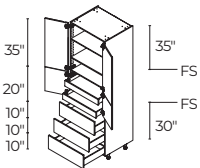

30" | T3DA302489.5I2

2 DOORS / 2 DRAWERS /
2 INNER DRAWERS

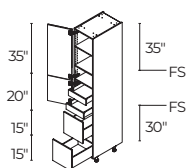

15" | T2D152489.5I2(L/R)
18" | T2D182489.5I2(L/R)
24" | T2D242489.5I2(L/R)

4 DOORS / 2 DRAWERS /
2 INNER DRAWERS

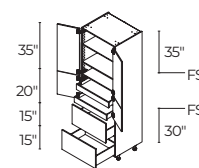

30" | T2D302489.5I2

89 1/2" H TALL APPLIANCE CABINETS >

MICRO/WALL OVEN ²
2 DOORS / 2 DRAWERS

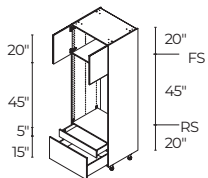

30" | TMO2D3089.5

MICRO/WALL OVEN ²
2 DOORS / 2 DRAWERS

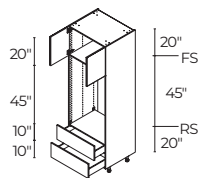

30" | TMO2DA3089.5

MICROWAVE ¹
4 DOORS

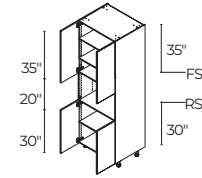

30" | TM3089.5

RS = Reinforced Shelf. FS = Fixed Shelf. Appliance cut-out sizes: (use of a filler is required and must be ordered separately):
¹28 1/2" width x 18 1/2" high. ²28 1/2" width x 43 1/2" high. ³28 1/2" width x 53 1/2" high. ⁴28 1/2" width x 28 1/2" high.

MICROWAVE ¹ 2 DOORS / 3 DRAWERS

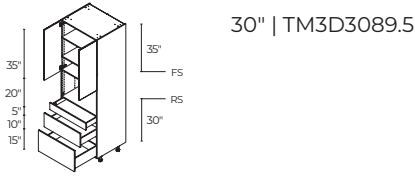

30" | TM3D3089.5

MICROWAVE ¹ 2 DOORS / 3 DRAWERS

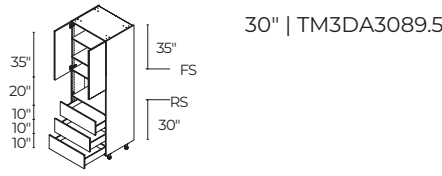

30" | TM3DA3089.5

MICROWAVE ¹ 2 DOORS / 2 DRAWERS

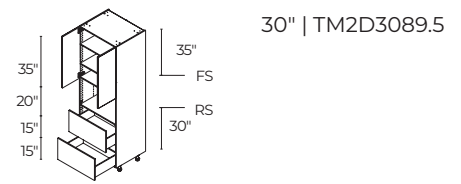

30" | TM2D3089.5

SINGLE OVEN ³ 4 DOORS

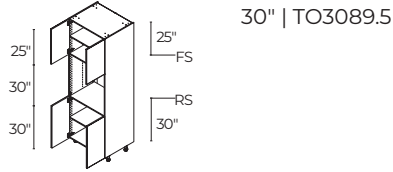

30" | TO3089.5

SINGLE OVEN ³ 2 DOORS / 3 DRAWERS

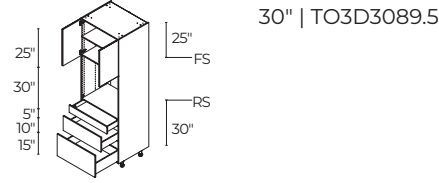

30" | TO3D3089.5

SINGLE OVEN ³ 2 DOORS / 3 DRAWERS

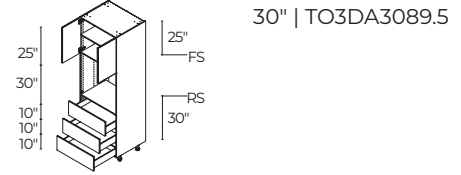

30" | TO3DA3089.5

SINGLE OVEN ³ 2 DOORS / 2 DRAWERS

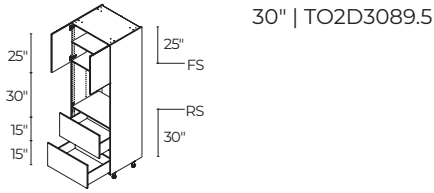

30" | TO2D3089.5

DOUBLE OVEN ³ 2 DOORS / 1 DRAWER

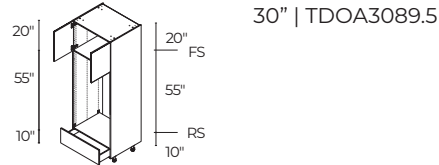

30" | TDOA3089.5

MICROWAVE ¹ 2 DOORS / 2 DRAWERS

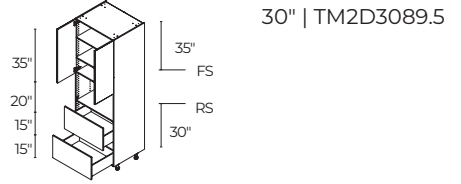

30" | TM2D3089.5

SINGLE OVEN ³ 4 DOORS

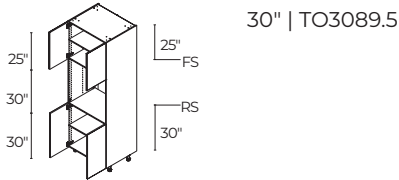

30" | TO3089.5

SINGLE OVEN ³ 2 DOORS / 3 DRAWERS

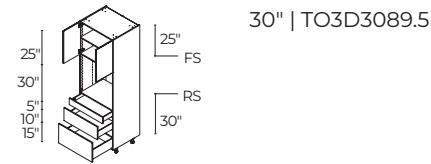

30" | TO3D3089.5

SINGLE OVEN ³ 2 DOORS / 3 DRAWERS

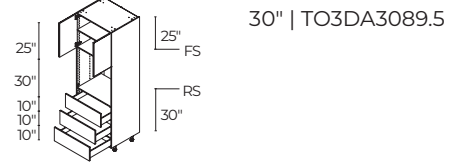

30" | TO3DA3089.5

SINGLE OVEN ³ 2 DOORS / 2 DRAWERS

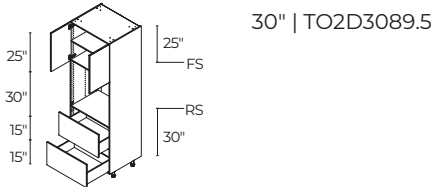

30" | TO2D3089.5

DOUBLE OVEN ³ 2 DOORS / 1 DRAWER

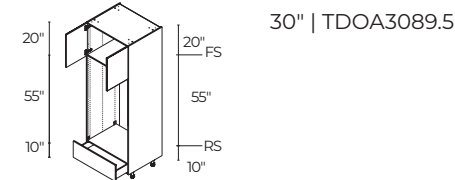

30" | TDOA3089.5

VANITY CABINETS

Produced with white interiors.

STANDARD VANITIES >

2 DOORS

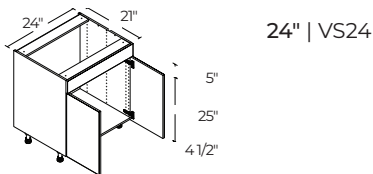

24" | VS24

2 DOORS

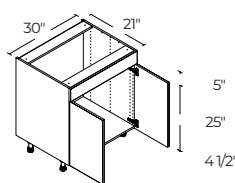

30" | VS30

2 DOORS

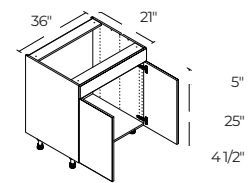

36" | VS36

RS = Reinforced Shelf. FS = Fixed Shelf. Appliance cut-out sizes: (use of a filler is required and must be ordered separately):
¹28 1/2" width x 18 1/2" high. ²28 1/2" width x 43 1/2" high. ³28 1/2" width x 53 1/2" high. ⁴28 1/2" width x 28 1/2" high.

1 DOOR / 1 DRAWER

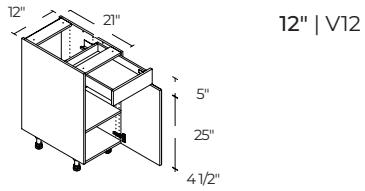

12" | V12

1 DOOR / 1 DRAWER

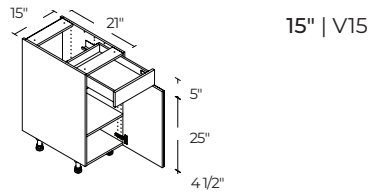

15" | V15

1 DOOR / 1 DRAWER

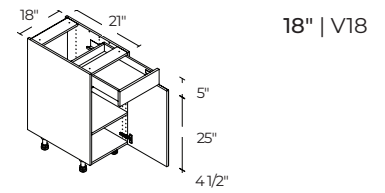

18" | V18

1 DOOR / 1 DRAWER

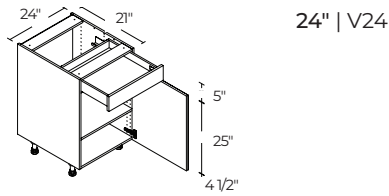

24" | V24

3 DRAWERS

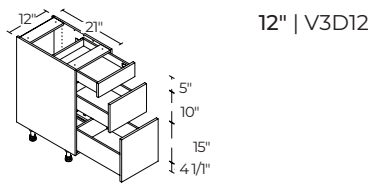

12" | V3D12

3 DRAWERS

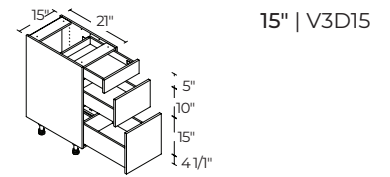

15" | V3D15

3 DRAWERS

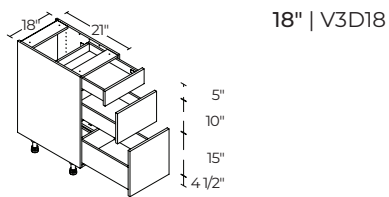

18" | V3D18

3 DRAWERS

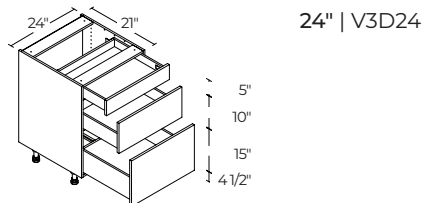

24" | V3D24

UNIVERSAL CABINETS

Produced with white interiors.

UNIVERSAL KITCHEN CABINETS >

2 DOORS

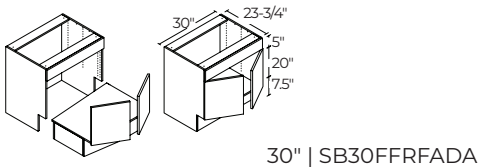

30" | SB30FFRFADA

2 DOORS

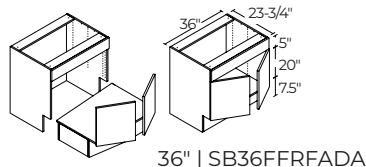

36" | SB36FFRFADA

1 DOOR / 1 DRAWER

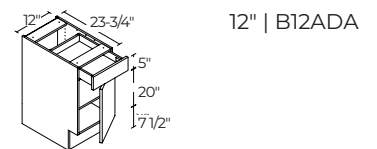

12" | B12ADA

1 DOOR / 1 DRAWER

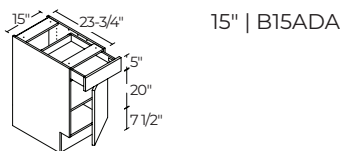

15" | B15ADA

1 DOOR / 1 DRAWER

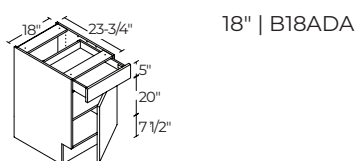

18" | B18ADA

1 DOOR / 1 DRAWER

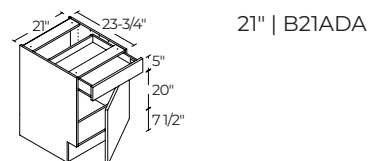

21" | B21ADA

1 DOOR / 1 DRAWER

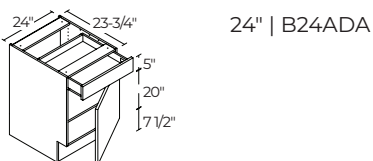

24" | B24ADA

1 DOOR / 1 DRAWER

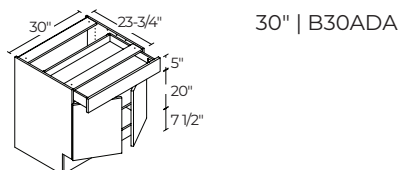

30" | B30ADA

1 DOOR / 1 DRAWER

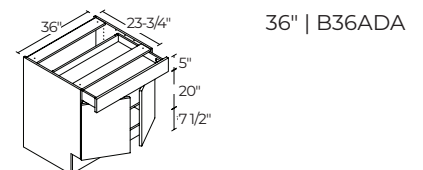

36" | B36ADA

Use CP1496 as toe-kick

RS = Reinforced Shelf. FS = Fixed Shelf. Appliance cut-out sizes: (use of a filler is required and must be ordered separately):¹ 28 1/2" width x 18 1/2" high. ²28 1/2" width x 43 1/2" high. ³28 1/2" width x 53 1/2" high. ⁴28 1/2" width x 28 1/2" high.

3 DRAWERS

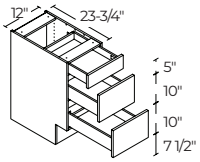

12" | B3D12ADA

3 DRAWERS

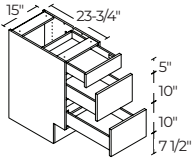

15" | B3D15ADA

3 DRAWERS

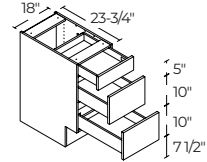

18" | B3D18ADA

3 DRAWERS

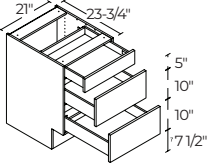

21" | B3D21ADA

3 DRAWERS

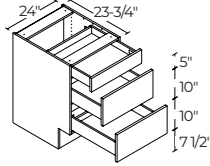

24" | B3D24ADA

UNIVERSAL VANITY CABINETS >

1 DOOR

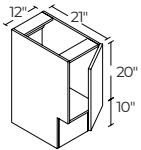

12" | V12ADA

1 DOOR

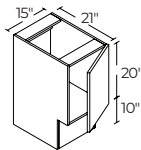

15" | V15ADA

1 DOOR

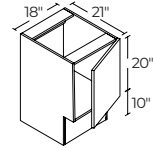

18" | V18ADA

1 DOOR

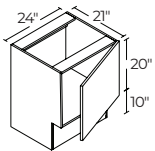

24" | V24ADA

2 DOORS

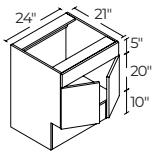

24" | VS24ADA

2 DOORS

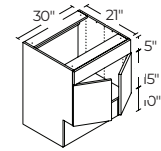

30" | VS30ADA

2 DOORS

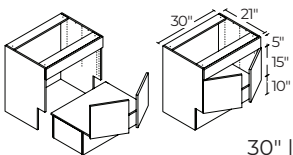

30" | VS30FFRFADA

2 DOORS

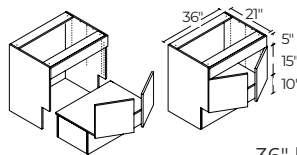

36" | VS36FFRFADA

3 DRAWERS

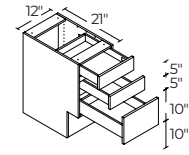

12" | V3D12ADA

3 DRAWERS

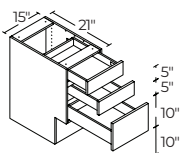

15" | V3D15ADA

3 DRAWERS

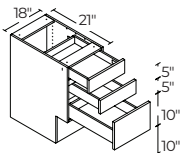

18" | V3D18ADA

3 DRAWERS

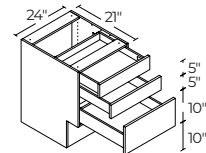

24" | V3D24ADA

FINISHING TOUCHES: COLOUR-MATCHED ACCESSORIES

Add stylish finishing touches to your project with our choice of colour-matched panels and trims, all designed to complete your kitchen beautifully. All of our cover panels and fillers are finished on both sides and all 4 edges.



Cove crown moulding
& glass doors



Base moulding



Hidden drawers
/ roll-out trays

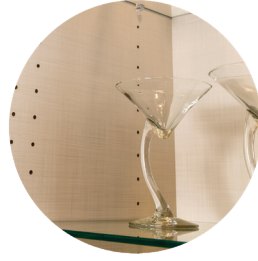

Internal glass shelves
/ designer linen interior



Floating shelves

COLOUR-MATCHED ACCESSORIES

WALL CABINET COVER PANEL 14 ¹³/₁₆"

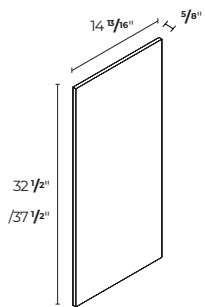

5/8 x 32 1/2" | CP1432
5/8 x 37 1/2" | CP1437

BASE CABINET COVER PANEL 24 ¹³/₁₆"

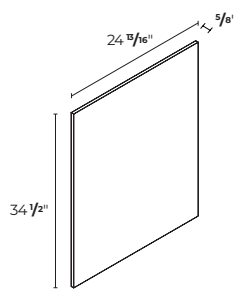

5/8 x 34 1/2" | CP2434

TALL CABINET COVER PANEL 14 ¹³/₁₆"

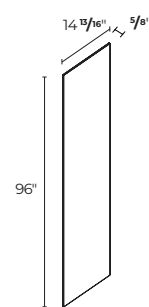

5/8 x 96" | CP1496

TALL CABINET
COVER PANEL 24 ¹³/₁₆"

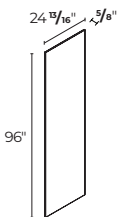

5/8 x 96" | CP2496

TALL CABINET
& FRIDGE GABLE COVER PANEL 36"

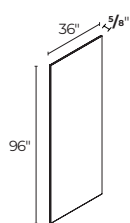

5/8 x 96" | CP3696

ISLAND PANEL 34 1/2"

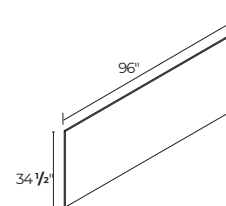

5/8 x 96" | CP3496

FILLER

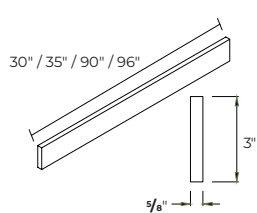

3 x 5/8 x 30" | F330
3 x 5/8 x 35" | F335
3 x 5/8 x 96" | F396
For Willow & Jasmine only:
3 x 5/8 x 90" | F390

FILLER

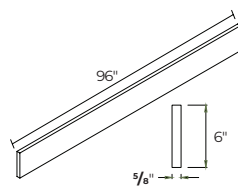

6 x 5/8 x 96" | F696

DECORATIVE MOULDING

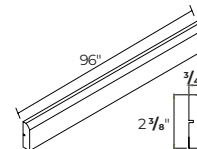

Available for Willow & Jasmine only
96 x 2 3/8 x 3/4" | DMC2.596

SCRIBE MOULDING

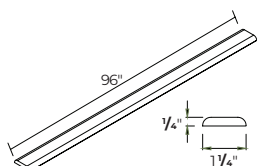

Not available for Cordyline
96 x 1/4 x 1 1/4" | SBM96

COVE CROWN MOULDING

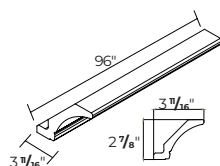

With integrated cleat
Not available for Cordyline
96 x 3 7/16 x 2 7/8" | CCM96C

COVE CROWN MOULDING

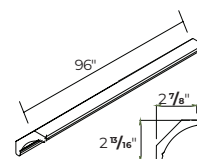

Without cleat
Not available for Cordyline
96 x 2 7/16 x 2 7/8" | CCM96NC

COVE PLAIN CROWN MOULDING

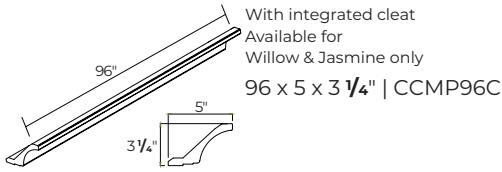

STRAIGHT LIGHT VALANCE MOULDING

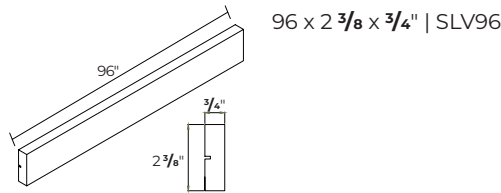

STRAIGHT LIGHT VALANCE MOULDING

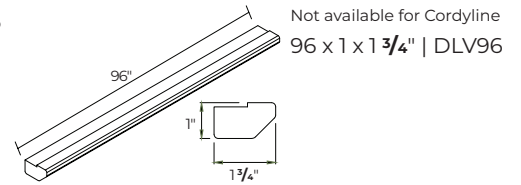

BASE MOULDING

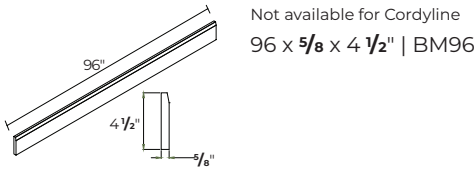

FURNITURE BASE MOULDING

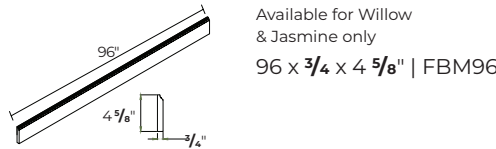

TOE-KICK

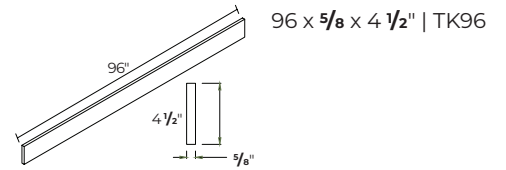

FLOATING SHELF

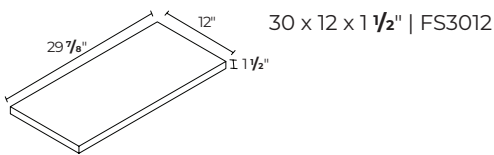

EDGE BANDING

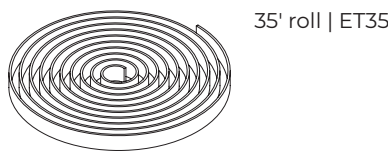

INTERIOR ACCESSORIES & HARDWARE

Designed to make everyday use of your kitchen a great experience, our specially designed interior accessories are made to our exacting Magick Home standards. Don't forget, the Magick Home range includes all the hardware and fittings you need from hinges to toe-kick clips.

INTERIOR ACCESSORIES >

CUTLERY TRAY 15"

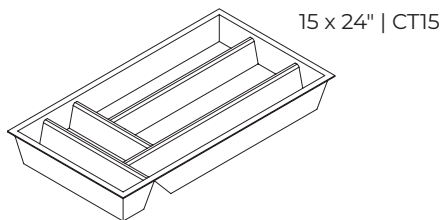

CUTLERY TRAY 18"

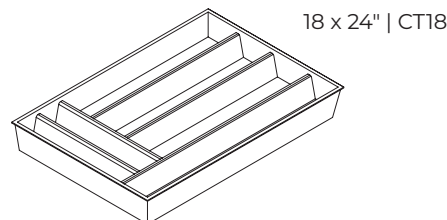

CUTLERY TRAY 24"

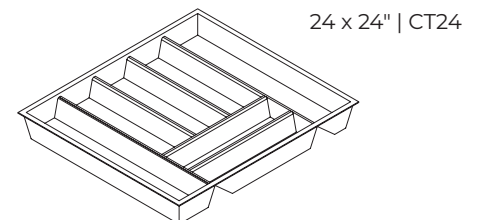

CUTLERY TRAY 30"

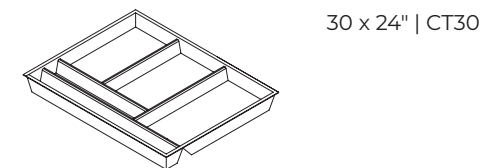

CUTLERY TRAY 36"

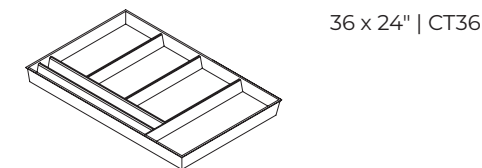

DRAWER MAT

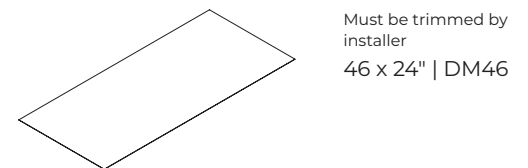

UNDER SINK MAT

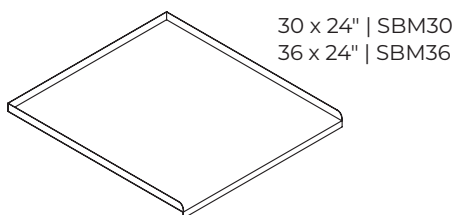

SHELVING 14"

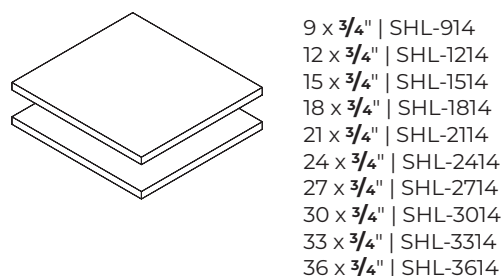

SHELVING 24"

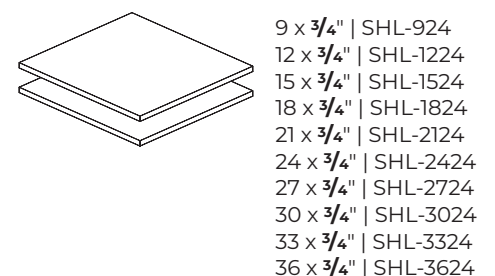

GLASS SHELVING 14"

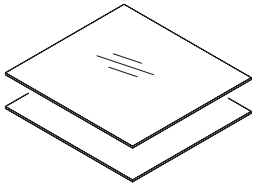

15 x 1/4" | GSHL-1514
18 x 1/4" | GSHL-1814
30 x 1/4" | GSHL-3014
36 x 1/4" | GSHL-3614

TOUCH-UP KIT (TUK)

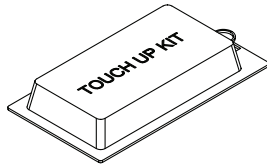

Available per collection finish. Kit includes one marker, one wax touch-up stick and one foam pad.

WALL CORNER SHELF 24"

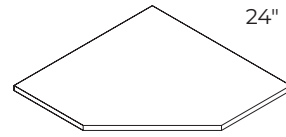

24" | SHL-2424 CORNER

WALL CORNER GLASS SHELVES 24"

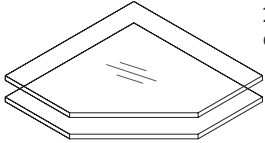

24" | GSHL-2424C
CORNER - PACK OF 2

SHALLOW INNER DRAWER KIT 14"

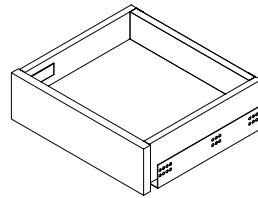

15 x 3 3/8" | DK1514
18 x 3 3/8" | DK1814
24 x 3 3/8" | DK2414

INNER DRAWER KIT 24"

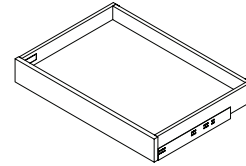

12 x 3 3/8" | DK1224
15 x 3 3/8" | DK1524
18 x 3 3/8" | DK1824
21 x 3 3/8" | DK2124
24 x 3 3/8" | DK2424
27 x 3 3/8" | DK2724
30 x 3 3/8" | DK3024
33 x 3 3/8" | DK3324
36 x 3 3/8" | DK3624

HARDWARE >

Hinges available in sets of 2.

110 DEGREE HINGE

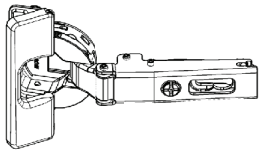

Used for standard doors
HIN110

155 DEGREE HINGE

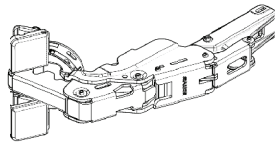

Must be used when adding interior drawers behind cabinet doors
HIN155

110 DEGREE BLIND CORNER HINGE

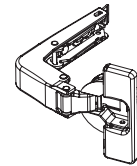

HINBC

PIE CUT HINGE

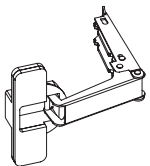

HINPC

DIAGONAL CORNER WALL HINGE

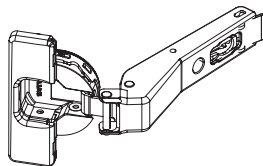

HIN45

HORIZONTAL LIFT-UP HINGE

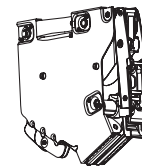

Used to create lift-up doors
HINLU



Lily and Willow



CREATE A
CUSTOM LOOK

Combining door styles adds a dynamic look to any room, creating visual interest and opening up your décor colour palette. Get creative and have fun with your space!



MAGICK HOME

 magickhome.com
 1 888 530 0013
 support.ca@magickhome.com

PROUD MEMBER OF THE

NKBA